

LEASE FACT SHEET: LEASE OPPORTUNITY

Lease Number:	E100114	Report Date:	04/17/20
Auction Registration			
Deadline:	May 19, 2020 - 5:00PM (MDT)	Public Auction Date:	May 21, 2020
Supervisory Area:	Priest Lake Supervisory Office	Public Auction Time:	1:00 pm (MDT)
Asset Classification:	Mineral Lease	Public Auction Location:	Telephone only - auction information provided upon registration.
County:	Bonner		
		Office Contact:	Dan Brown
		Office Number:	(208) 443-2516

EXPIRING LEASE

Lease Status:	N/A	Primary Current Use:	N/A
Lease Start Date:	N/A		
Lease End Date:	N/A		

PROPOSED LEASE

Lease Start Date:	03/01/2020	Proposed Primary Activity:	Mining
Lease End Date:	02/28/2025	Commodity Type:	Boulders
Proposed Term Length:	5 Years	Total Proposed Acres:	Approximately 11
Access:	Yes	Animal Unit Months (AUM):	N/A
First Year Rent:	\$160.00	Water Rights:	N/A
Annual Increase:	N/A	Secondary Current Use:	N/A
Royalty:	\$15.00/short ton; or \$22.50/loose cubic yard	Proposed Higher or Better Use:	Alternative uses may be proposed to IDL
Proposed Special Terms & Conditions:	See draft lease	Related Instruments:	N/A

DISCLAIMER: The Idaho Department of Lands (IDL) provides this product for informational purposes only. Consumers of this information should review or consult the primary data and information sources to ascertain the viability of the information for their purposes. IDL provides these data in good faith and in no event shall be liable for any incorrect information, result or analysis, any lost profits and special, indirect or consequential damages to any party, arising out of or in connection with the use or the inability to use the data or the product provided. IDL makes this data and product available as a convenience to the public, and for no other purpose. IDL reserves the right to change or revise published data and/or the product at any time.

Exhibit A: LEGAL DESCRIPTION

TWN	RNG	SEC	Legal Description	County	Endow	Acres	Grazing Acres	Dry Acres	Irrigated Acres	CRP Acres	Waste Acres	PHMA Acres	IHMA Acres	AUMs
61 N	4W	2	Pts of S2NE	Bonner	UI	Approx. 11								

DISCLAIMER: The Idaho Department of Lands (IDL) provides this product for informational purposes only. Consumers of this information should review or consult the primary data and information sources to ascertain the viability of the information for their purposes. IDL provides these data in good faith and in no event shall be liable for any incorrect information, result or analysis, any lost profits and special, indirect or consequential damages to any party, arising out of or in connection with the use or the inability to use the data or the product provided. IDL makes this data and product available as a convenience to the public, and for no other purpose. IDL reserves the right to change or revise published data and/or the product at any time.

Exhibit B: EXISTING IMPROVEMENTS

IMPROVEMENT	OWNERSHIP	ADDITIONAL BILLED USE
N/A	N/A	N/A

DISCLAIMER: The Idaho Department of Lands (IDL) provides this product for informational purposes only. Consumers of this information should review or consult the primary data and information sources to ascertain the viability of the information for their purposes. IDL provides these data in good faith and in no event shall be liable for any incorrect information, result or analysis, any lost profits and special, indirect or consequential damages to any party, arising out of or in connection with the use or the inability to use the data or the product provided. IDL makes this data and product available as a convenience to the public, and for no other purpose. IDL reserves the right to change or revise published data and/or the product at any time.

Exhibit C: VICINITY MAP

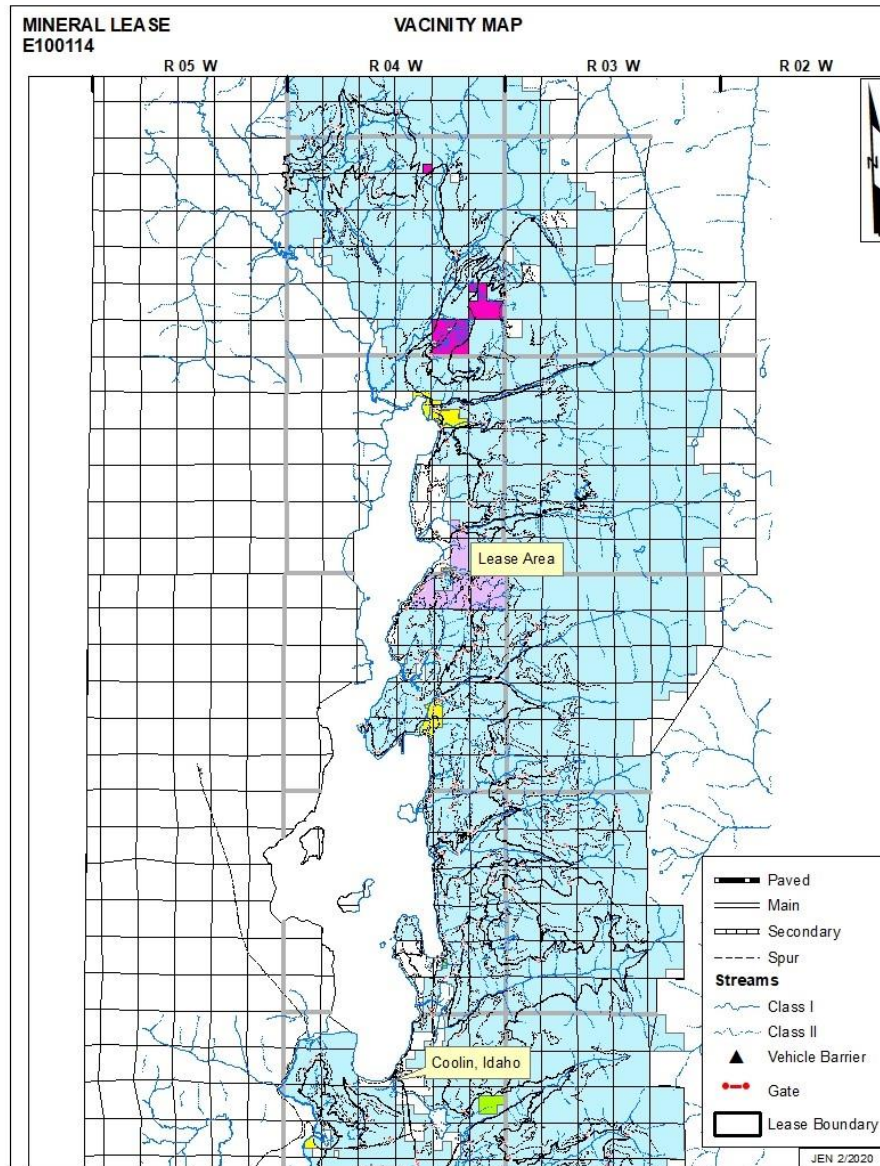

DISCLAIMER: The Idaho Department of Lands (IDL) provides this product for informational purposes only. Consumers of this information should review or consult the primary data and information sources to ascertain the viability of the information for their purposes. IDL provides these data in good faith and in no event shall be liable for any incorrect information, result or analysis, any lost profits and special, indirect or consequential damages to any party, arising out of or in connection with the use or the inability to use the data or the product provided. IDL makes this data and product available as a convenience to the public, and for no other purpose. IDL reserves the right to change or revise published data and/or the product at any time.

Exhibit D: LEASE MAP

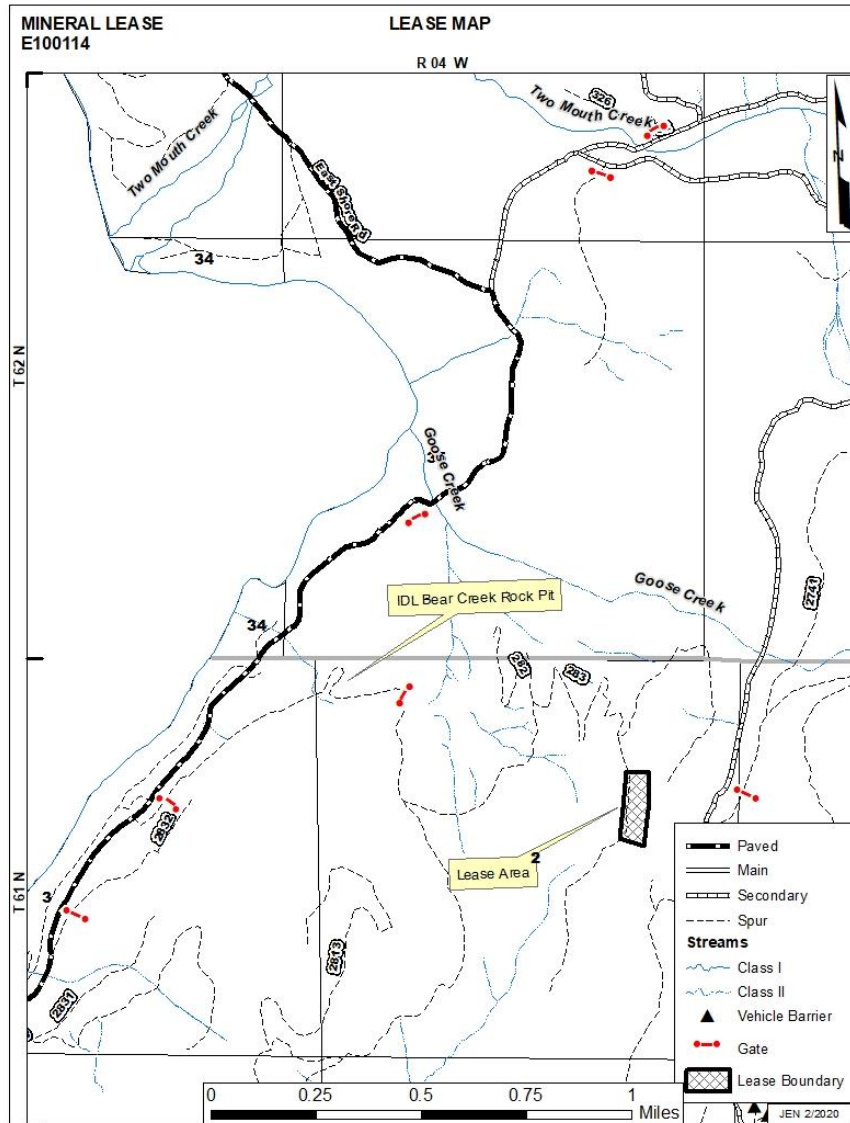

DISCLAIMER: The Idaho Department of Lands (IDL) provides this product for informational purposes only. Consumers of this information should review or consult the primary data and information sources to ascertain the viability of the information for their purposes. IDL provides these data in good faith and in no event shall be liable for any incorrect information, result or analysis, any lost profits and special, indirect or consequential damages to any party, arising out of or in connection with the use or the inability to use the data or the product provided. IDL makes this data and product available as a convenience to the public, and for no other purpose. IDL reserves the right to change or revise published data and/or the product at any time.