



## LEASE FACT SHEET: LEASE OPPORTUNITY

**Lease Number:** GR60000650  
**Applications Accepted:** 1/1/2021 - 4/30/2021  
**Supervisory Area:** Southwest  
**Asset Classification:** Rangeland  
**County:** Elmore

**Report Date:** 12/29/2020  
**Public Auction Date:** TBD  
**Office Contact:** Dean Johnson  
**Office Number:** 208-334-3488

---

### EXPIRING LEASE

**Expiring Lease #:** G600198  
**Lease Start Date:** 1/1/2017  
**Lease End Date:** 12/31/2021

**Primary Current Use:** Grazing

### PROPOSED LEASE

**Lease Start Date:** 1/1/2022  
**Lease End Date:** 12/31/2031  
**Proposed Term Length:** 10 Yrs  
**Access:** Contact Area Office  
**First Year Rent:** TBD  
**Annual Increase:** No

**Proposed Primary Activity:** Grazing  
**Commodity Type:** Cattle  
**Total Proposed Acres:** 10,261.28  
**Animal Unit Months (AUM):** 1,076  
**Water Rights:** 61-4064, 61-10005, 61-110580

**Secondary Current Use:** M60069 Military lease, please contact the area office for more information.

**Proposed Higher or Better Use:** Alternative uses may be proposed to IDL

**Royalty:** N/A

**Proposed Special Terms & Conditions:**  
**See Lease Draft**

**Related Instruments:** N/A



**Exhibit A: LEGAL DESCRIPTION**

TWN	RNG	SEC	Legal Description	County	Endow	Total Acres	Grazing Acres	Dryland Acres	Irrigated Acres	CRP Acres	Waste Acres	PHMA Acres	IHMA Acres	AUMS
03S	05E	13	ALL	Elmore	AC	640.00	640.00	0.00	0.00	0.00	0.00	0.00	0.00	107.00
03S	05E	26	ALL	Elmore	AC	640.00	640.00	0.00	0.00	0.00	0.00	0.00	0.00	53.00
03S	06E	20	ALL	Elmore	AC	640.00	640.00	0.00	0.00	0.00	0.00	0.00	0.00	64.00
03S	06E	19	ALL	Elmore	AC	650.28	650.28	0.00	0.00	0.00	0.00	0.00	0.00	65.00
03S	06E	18	ALL, LOTS 1-4(W2W2)	Elmore	AC	651.00	651.00	0.00	0.00	0.00	0.00	0.00	0.00	65.00
03S	05E	33	ALL	Elmore	AC	640.00	640.00	0.00	0.00	0.00	0.00	0.00	0.00	53.00
03S	05E	32	ALL	Elmore	NS	640.00	640.00	0.00	0.00	0.00	0.00	0.00	0.00	60.00
03S	05E	29	ALL	Elmore	NS	640.00	640.00	0.00	0.00	0.00	0.00	0.00	0.00	71.00
03S	05E	27	ALL	Elmore	AC	640.00	640.00	0.00	0.00	0.00	0.00	0.00	0.00	53.00
03S	05E	25	ALL	Elmore	AC	640.00	640.00	0.00	0.00	0.00	0.00	0.00	0.00	71.00
03S	05E	24	ALL	Elmore	AC	640.00	640.00	0.00	0.00	0.00	0.00	0.00	0.00	85.00
03S	05E	23	ALL	Elmore	AC	640.00	640.00	0.00	0.00	0.00	0.00	0.00	0.00	85.00
03S	05E	22	ALL	Elmore	NS	640.00	640.00	0.00	0.00	0.00	0.00	0.00	0.00	68.00
03S	05E	28	ALL	Elmore	AC	640.00	640.00	0.00	0.00	0.00	0.00	0.00	0.00	53.00
03S	05E	14	ALL	Elmore	NS	640.00	640.00	0.00	0.00	0.00	0.00	0.00	0.00	69.00
03S	05E	21	ALL	Elmore	NS	640.00	640.00	0.00	0.00	0.00	0.00	0.00	0.00	54.00
						10,261.28	10,261.28	0.00	0.00	0.00	0.00	0.00	0.00	1,076.00

DISCLAIMER: The Idaho Department of Lands (IDL) provides this product for informational purposes only. Consumers of this information should review or consult the primary data and information sources to ascertain the viability of the information for their purposes. IDL provides these data in good faith and in no event, shall be liable for any incorrect information, result or analysis, any lost profits and special, indirect or consequential damages to any party, arising out of or in connection with the use or the inability to use the data or the product provided. IDL makes this data and product available as a convenience to the public, and for no other purpose. IDL reserves the right to change or revise published data and/or the product at any time.



**Exhibit B: EXISTING IMPROVEMENTS**

IMPROVEMENT	OWNERSHIP	ADDITIONAL BILLED USE

DISCLAIMER: The Idaho Department of Lands (IDL) provides this product for informational purposes only. Consumers of this information should review or consult the primary data and information sources to ascertain the viability of the information for their purposes. IDL provides these data in good faith and in no event, shall be liable for any incorrect information, result or analysis, any lost profits and special, indirect or consequential damages to any party, arising out of or in connection with the use or the inability to use the data or the product provided. IDL makes this data and product available as a convenience to the public, and for no other purpose. IDL reserves the right to change or revise published data and/or the product at any time.



Exhibit C: VICINITY MAP

G600198  
T03S03E Sec 14,21,22,23,26,27,28,29,32,33

Map 1

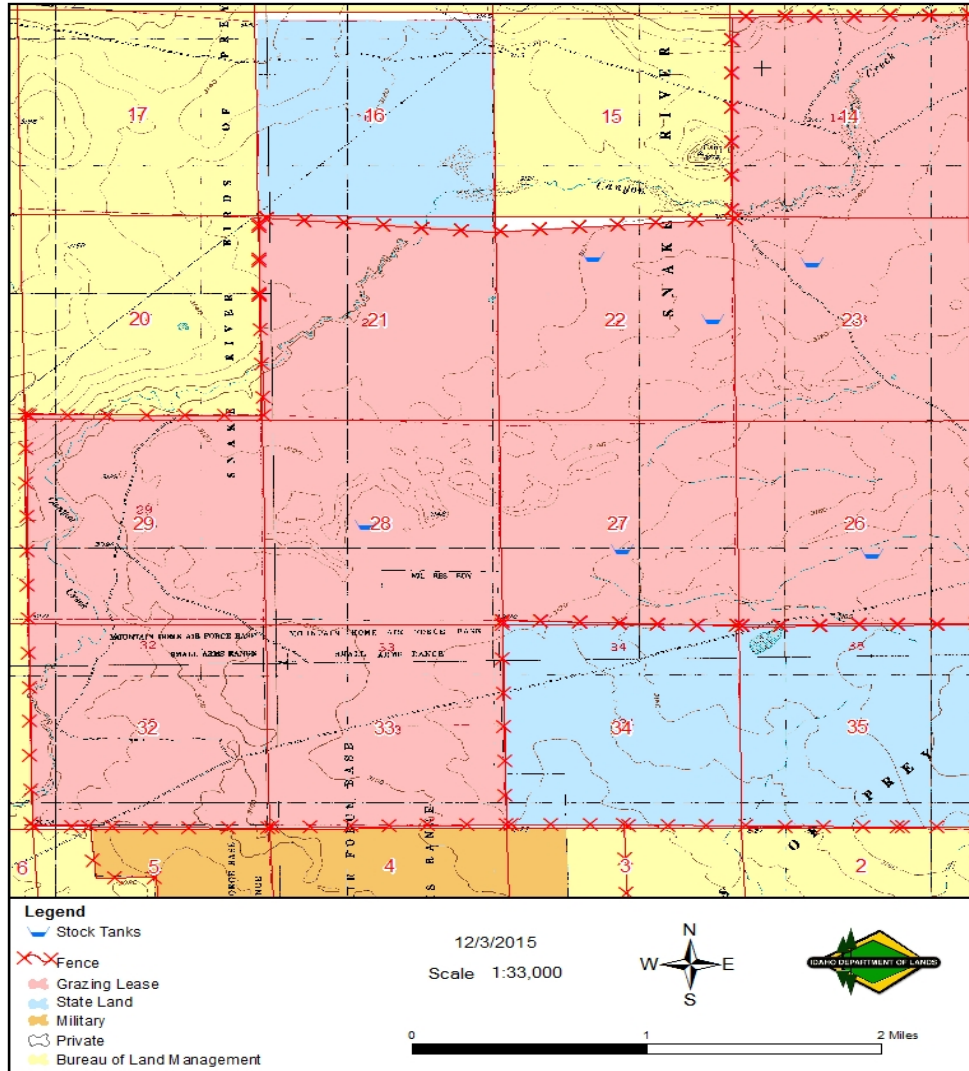

DISCLAIMER: The Idaho Department of Lands (IDL) provides this product for informational purposes only. Consumers of this information should review or consult the primary data and information sources to ascertain the viability of the information for their purposes. IDL provides these data in good faith and in no event, shall be liable for any incorrect information, result or analysis, any lost profits and special, indirect or consequential damages to any party, arising out of or in connection with the use or the inability to use the data or the product provided. IDL makes this data and product available as a convenience to the public, and for no other purpose. IDL reserves the right to change or revise published data and/or the product at any time.



Exhibit D: LEASE MAP

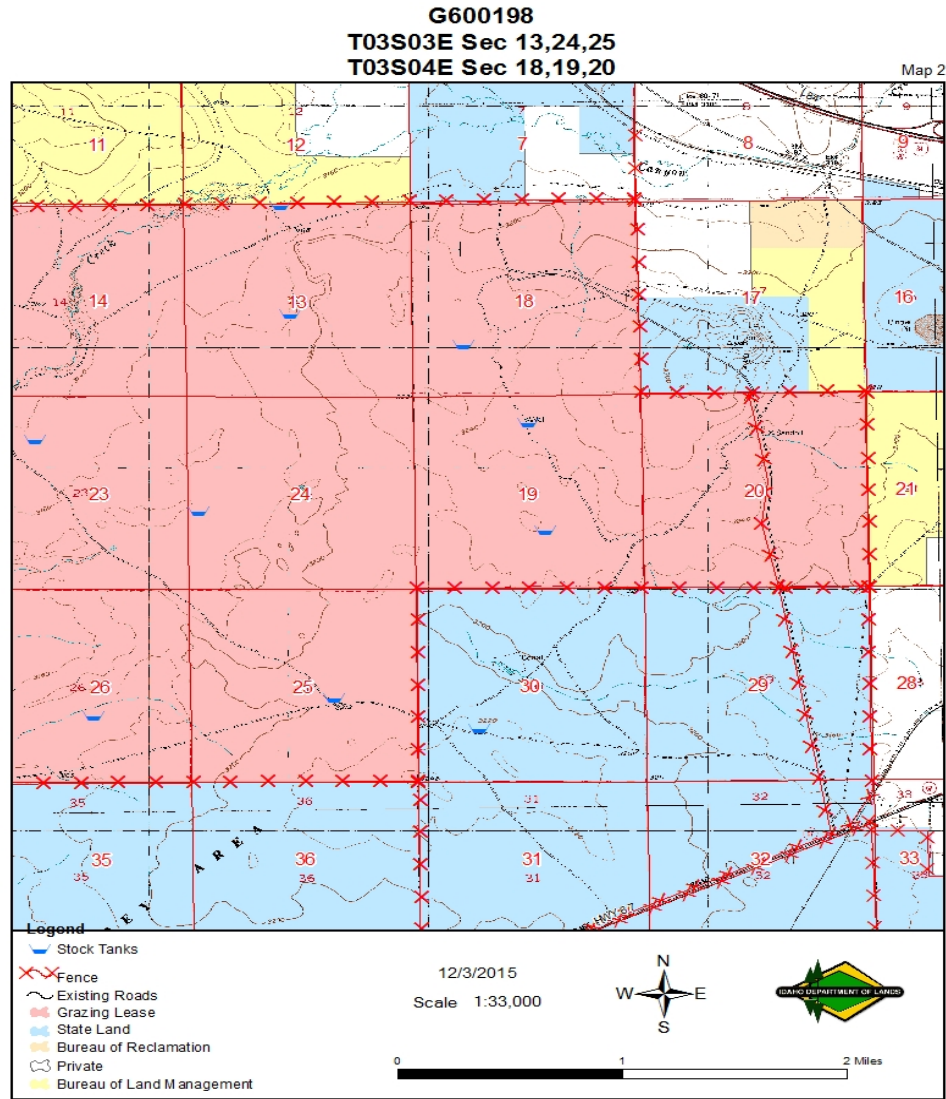

DISCLAIMER: The Idaho Department of Lands (IDL) provides this product for informational purposes only. Consumers of this information should review or consult the primary data and information sources to ascertain the viability of the information for their purposes. IDL provides these data in good faith and in no event, shall be liable for any incorrect information, result or analysis, any lost profits and special, indirect or consequential damages to any party, arising out of or in connection with the use or the inability to use the data or the product provided. IDL makes this data and product available as a convenience to the public, and for no other purpose. IDL reserves the right to change or revise published data and/or the product at any time.