



## **LEASE FACT SHEET: LEASE OPPORTUNITY**

**Lease Number: G300002**

**Applications Accepted: 1/1/2022 - 4/30/2022**

**Supervisory Area: St. Joe**

**Asset Classification: Timberland**

**County: Benewah**

**Report Date: 12/31/2019**

**Public Auction Date: TBD**

**Office Contact: Rick Arcano**

**Office Number: 208-245-4551**

---

## **EXPIRING LEASE**

**Lease Start Date: 1/1/2013**

**Lease End Date: 12/31/2022**

**Primary Current Use: Grazing**

## **PROPOSED LEASE**

**Lease Start Date: 1/1/2023**

**Lease End Date: TBD**

**Proposed Term Length: TBD**

**Access: Contact Area Office**

**First Year Rent: TBD**

**Annual Increase: No**

**Royalty: N/A**

**Proposed Primary Activity: Grazing**

**Commodity Type: Cattle**

**Total Proposed Acres: 8**

**Animal Unit Months (AUM): 2**

**Water Rights: N/A**

**Secondary Current Use: N/A**

**Proposed Higher or Better Use: Alternative uses may be proposed to IDL**

**Proposed Special Terms & Conditions:**

**See Lease Draft**

**Related Instruments: N/A**

DISCLAIMER: The Idaho Department of Lands (IDL) provides this product for informational purposes only. Consumers of this information should review or consult the primary data and information sources to ascertain the viability of the information for their purposes. IDL provides these data in good faith and in no event, shall be liable for any incorrect information, result or analysis, any lost profits and special, indirect or consequential damages to any party, arising out of or in connection with the use or the inability to use the data or the product provided. IDL makes this data and product available as a convenience to the public, and for no other purpose. IDL reserves the right to change or revise published data and/or the product at any time.



### Exhibit A: LEGAL DESCRIPTION

TWN	RNG	SEC	Legal Description	County	Endow	Total Acres	Grazing Acres	Dryland Acres	Irrigated Acres	CRP Acres	Waste Acres	PHMA Acres	IHMA Acres	AUMS
44N	01W	26	Pts N2NE (lying N of State Highway #3)	Benewah	CAP	8.00	8.00	0.00	0.00	0.00	0.00	0.00	0.00	2.00

DISCLAIMER: The Idaho Department of Lands (IDL) provides this product for informational purposes only. Consumers of this information should review or consult the primary data and information sources to ascertain the viability of the information for their purposes. IDL provides these data in good faith and in no event, shall be liable for any incorrect information, result or analysis, any lost profits and special, indirect or consequential damages to any party, arising out of or in connection with the use or the inability to use the data or the product provided. IDL makes this data and product available as a convenience to the public, and for no other purpose. IDL reserves the right to change or revise published data and/or the product at any time.



**Exhibit B: EXISTING IMPROVEMENTS**

IMPROVEMENT	OWNERSHIP	ADDITIONAL BILLED USE

DISCLAIMER: The Idaho Department of Lands (IDL) provides this product for informational purposes only. Consumers of this information should review or consult the primary data and information sources to ascertain the viability of the information for their purposes. IDL provides these data in good faith and in no event, shall be liable for any incorrect information, result or analysis, any lost profits and special, indirect or consequential damages to any party, arising out of or in connection with the use or the inability to use the data or the product provided. IDL makes this data and product available as a convenience to the public, and for no other purpose. IDL reserves the right to change or revise published data and/or the product at any time.



Exhibit C: VICINITY MAP

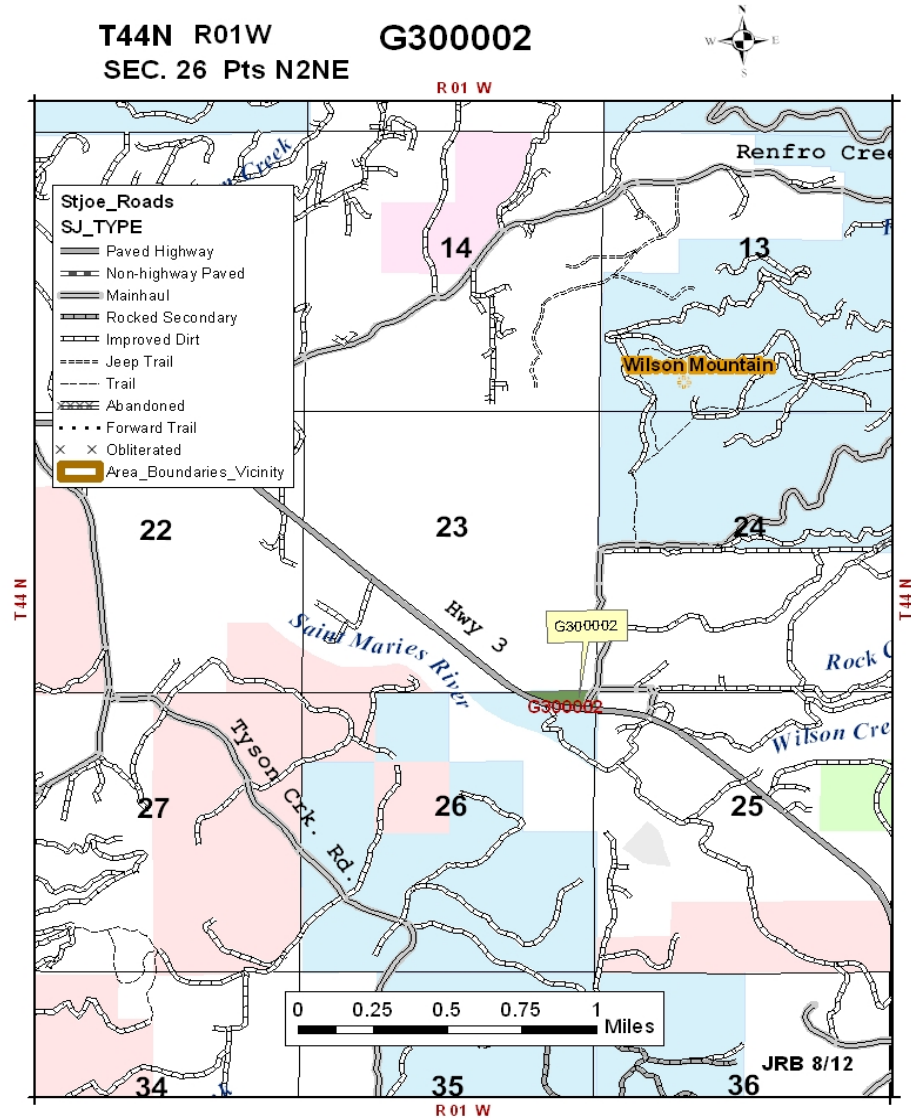

DISCLAIMER: The Idaho Department of Lands (IDL) provides this product for informational purposes only. Consumers of this information should review or consult the primary data and information sources to ascertain the viability of the information for their purposes. IDL provides these data in good faith and in no event, shall be liable for any incorrect information, result or analysis, any lost profits and special, indirect or consequential damages to any party, arising out of or in connection with the use or the inability to use the data or the product provided. IDL makes this data and product available as a convenience to the public, and for no other purpose. IDL reserves the right to change or revise published data and/or the product at any time.