

LEASE FACT SHEET: LEASE OPPORTUNITY

Report Date: 12/17/2020

Lease Number: TBD
IDL Supervisory Area: Ponderosa
IDL Office Contact: Chris Tretter
IDL Office Phone Number: (208) 877-1121
Asset Classification: Mineral
County: Latah

Applications Accepted:
Public Auction Registration Deadline: TBD
Public Auction Start Date/Time: TBD
Public Auction End Date/Time: TBD
Public Auction Location: TBD

Contact Area Office*

EXPIRING LEASE

Lease Number: E410006*
Lease Start Date: March 1, 2013
Lease End Date: February 28, 2023*

Primary Current Use: Mining
Number of Tracts: N/A

* Please note that the expiring lease may be extended by IDL prior to the expiration date due to production or other criteria identified in Idaho law. Please contact IDL Staff regarding the status of an expiring lease prior to applying for a new lease.

PROPOSED LEASE

Lease Start Date: March 1, 2023
Lease End Date: TBD
Proposed Term Length: Up to 20 years
Access: Yes
First Year Rent: \$1,113.25
Annual Rent Increase: 3%
Minimum Annual Royalty: \$1,000.00
Royalty: TBD
Proposed Special Terms & Conditions: TBD

Proposed Primary Activity: Mining
Commodity Type: Salable
Total Proposed Acres: 377.75
Animal Unit Months (AUM): N/A
Water Rights: N/A

Secondary Current Use: N/A
Proposed Higher or Better Use: Alternative uses may be proposed to IDL

Related Instruments: N/A

DISCLAIMER: The Idaho Department of Lands (IDL) provides this product for informational purposes only. Consumers of this information should review or consult the primary data and information sources to ascertain the viability of the information for their purposes. IDL provides these data in good faith and in no event shall be liable for any incorrect information, result or analysis, any lost profits and special, indirect or consequential damages to any party, arising out of or in connection with the use or the inability to use the data or the product provided. IDL makes this data and product available as a convenience to the public, and for no other purpose. IDL reserves the right to change or revise published data and/or the product at any time.

EXHIBIT A: LEGAL DESCRIPTION

TWN	RNG	SEC	Legal Description	County	Endow	Acres	Grazing Acres	Dry Acres	Irrigated Acres	CRP Acres	Waste Acres	PHMA Acres	IHMA Acres	AUMs
41N	01E	18	Part Govt Lot 2, NE, E2NW, W2SE, W2SESE	Latah	PS	377.75								

DISCLAIMER: The Idaho Department of Lands (IDL) provides this product for informational purposes only. Consumers of this information should review or consult the primary data and information sources to ascertain the viability of the information for their purposes. IDL provides these data in good faith and in no event shall be liable for any incorrect information, result or analysis, any lost profits and special, indirect or consequential damages to any party, arising out of or in connection with the use or the inability to use the data or the product provided. IDL makes this data and product available as a convenience to the public, and for no other purpose. IDL reserves the right to change or revise published data and/or the product at any time.

EXHIBIT B: EXISTING IMPROVEMENTS

IMPROVEMENT	OWNERSHIP	ADDITIONAL BILLED USE
None		

DISCLAIMER: The Idaho Department of Lands (IDL) provides this product for informational purposes only. Consumers of this information should review or consult the primary data and information sources to ascertain the viability of the information for their purposes. IDL provides these data in good faith and in no event shall be liable for any incorrect information, result or analysis, any lost profits and special, indirect or consequential damages to any party, arising out of or in connection with the use or the inability to use the data or the product provided. IDL makes this data and product available as a convenience to the public, and for no other purpose. IDL reserves the right to change or revise published data and/or the product at any time.

EXHIBIT C: LEASE MAP

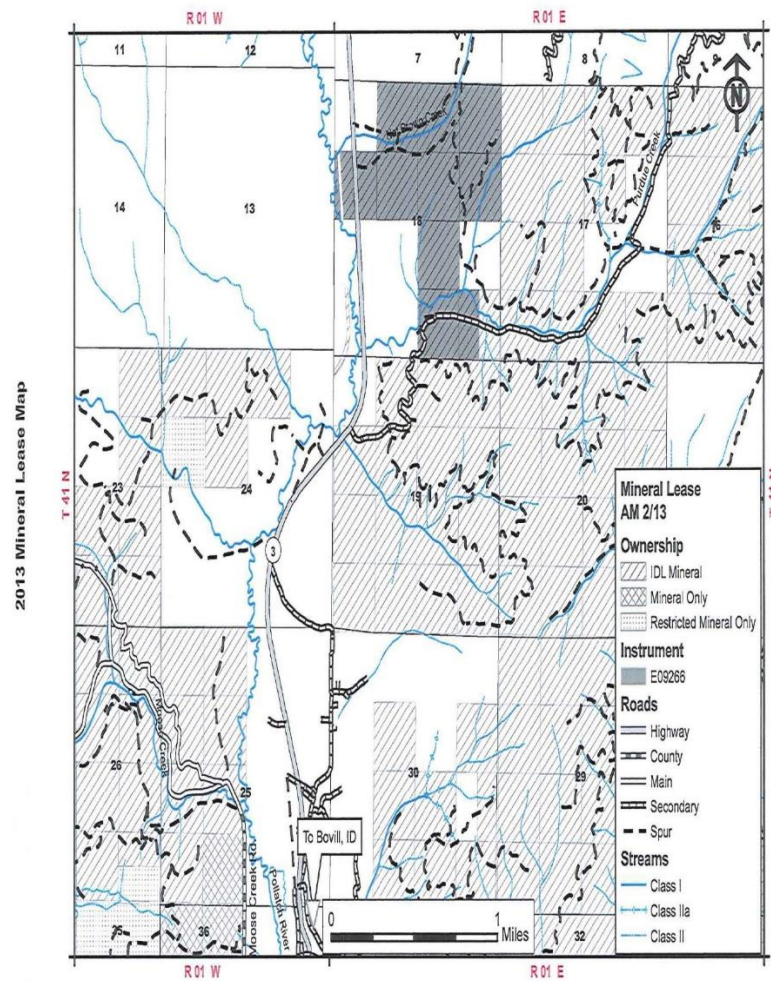

DISCLAIMER: The Idaho Department of Lands (IDL) provides this product for informational purposes only. Consumers of this information should review or consult the primary data and information sources to ascertain the viability of the information for their purposes. IDL provides these data in good faith and in no event shall be liable for any incorrect information, result or analysis, any lost profits and special, indirect or consequential damages to any party, arising out of or in connection with the use or the inability to use the data or the product provided. IDL makes this data and product available as a convenience to the public, and for no other purpose. IDL reserves the right to change or revise published data and/or the product at any time.