

LEASE FACT SHEET: LEASE OPPORTUNITY

Report Date: 12/7/2021

Lease Number:	TBD	Applications Accepted:	01/01/2024 – 04/30/2024
IDL Supervisory Area:	Pend Oreille Lake	Public Auction Registration Deadline:	TBD
IDL Office Contact:	Tom Fleer	Public Auction Start Date/Time:	TBD
IDL Office Phone Number:	(208) 263-5104	Public Auction End Date/Time:	TBD
Asset Classification:	Timber	Public Auction Location:	TBD
County:	Bonner County		

EXPIRING LEASE

Lease Number:	G200004	Primary Current Use:	Grazing
Lease Start Date:	01/01/2015	Number of Tracts:	N/A
Lease End Date:	12/31/2024		

PROPOSED LEASE

Lease Start Date:	01/01/2025	Proposed Primary Activity:	Grazing
Lease End Date:	12/31/2044	Commodity Type:	Cattle
Proposed Term Length:	20 YEARS	Total Proposed Acres:	640
Access:	YES	Animal Unit Months (AUM):	70
First Year Rent:	TBD	Water Rights:	N/A
Annual Rent Increase:	NA	Secondary Current Use:	N/A
Royalty:	N/A	Proposed Higher or Better Use:	Alternative uses may be proposed to IDL
Proposed Special Terms & Conditions:	Will vary based on lease, please contact area for more information.	Related Instruments:	N/A

EXHIBIT A: LEGAL DESCRIPTION

DISCLAIMER: The Idaho Department of Lands (IDL) provides this product for informational purposes only. Consumers of this information should review or consult the primary data and information sources to ascertain the viability of the information for their purposes. IDL provides these data in good faith and in no event shall be liable for any incorrect information, result or analysis, any lost profits and special, indirect or consequential damages to any party, arising out of or in connection with the use or the inability to use the data or the product provided. IDL makes this data and product available as a convenience to the public, and for no other purpose. IDL reserves the right to change or revise published data and/or the product at any time.

TWN	RNG	SEC	Legal Description	County	Endow	Total Acres	Grazing Acres	Dry Acres	Irrigated Acres	CRP Acres	Waste Acres	PHMA Acres	IHMA Acres	AUMs
57N	05W	36	ALL	Bonner County	PS	640	640	0	0	0	0	0	0	70

EXHIBIT B: EXISTING IMPROVEMENTS

DISCLAIMER: The Idaho Department of Lands (IDL) provides this product for informational purposes only. Consumers of this information should review or consult the primary data and information sources to ascertain the viability of the information for their purposes. IDL provides these data in good faith and in no event shall be liable for any incorrect information, result or analysis, any lost profits and special, indirect or consequential damages to any party, arising out of or in connection with the use or the inability to use the data or the product provided. IDL makes this data and product available as a convenience to the public, and for no other purpose. IDL reserves the right to change or revise published data and/or the product at any time.

IMPROVEMENT**OWNERSHIP****ADDITIONAL BILLED USE**

IMPROVEMENT	OWNERSHIP	ADDITIONAL BILLED USE
N/A		

DISCLAIMER: The Idaho Department of Lands (IDL) provides this product for informational purposes only. Consumers of this information should review or consult the primary data and information sources to ascertain the viability of the information for their purposes. IDL provides these data in good faith and in no event shall be liable for any incorrect information, result or analysis, any lost profits and special, indirect or consequential damages to any party, arising out of or in connection with the use or the inability to use the data or the product provided. IDL makes this data and product available as a convenience to the public, and for no other purpose. IDL reserves the right to change or revise published data and/or the product at any time.

EXHIBIT C: VICINITY MAP

G200004 Site Map
Section 36, Township 57 North, Range 5 West, B. M.

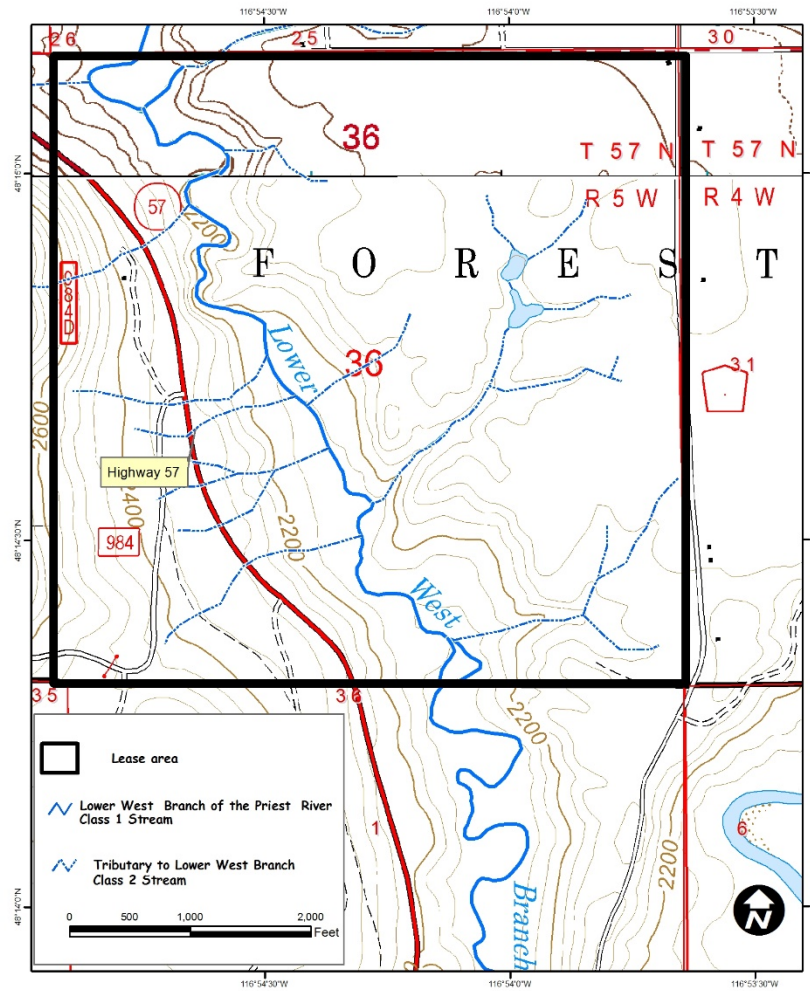

DISCLAIMER: The Idaho Department of Lands (IDL) provides this product for informational purposes only. Consumers of this information should review or consult the primary data and information sources to ascertain the viability of the information for their purposes. IDL provides these data in good faith and in no event shall be liable for any incorrect information, result or analysis, any lost profits and special, indirect or consequential damages to any party, arising out of or in connection with the use or the inability to use the data or the product provided. IDL makes this data and product available as a convenience to the public, and for no other purpose. IDL reserves the right to change or revise published data and/or the product at any time.