

NOTE:
THE USGS LAKE PEND ORELLE SUMMER POOL ELEVATION IS 2,062.5 FT-NGVD29. THIS WAS CONVERTED TO 2,066.37 FT-NAVD88 FOR USE AS THE ORDINARY HIGH WATER (OHW).

THE USGS LAKE PEND ORELLE WINTER POOL ELEVATION IS 2,051.0 FT-NGVD29. THIS WAS CONVERTED TO 2,054.87 FT-NAVD88 FOR USE AS THE APPROXIMATE LOW WATER.

270 TOTAL SLIPS. ALL SLIPS MAY HAVE LIFTS AND COVERS.

NO SIDE TIES ALONG LITTORAL OFFSET ADJACENT TO THE LODGE.

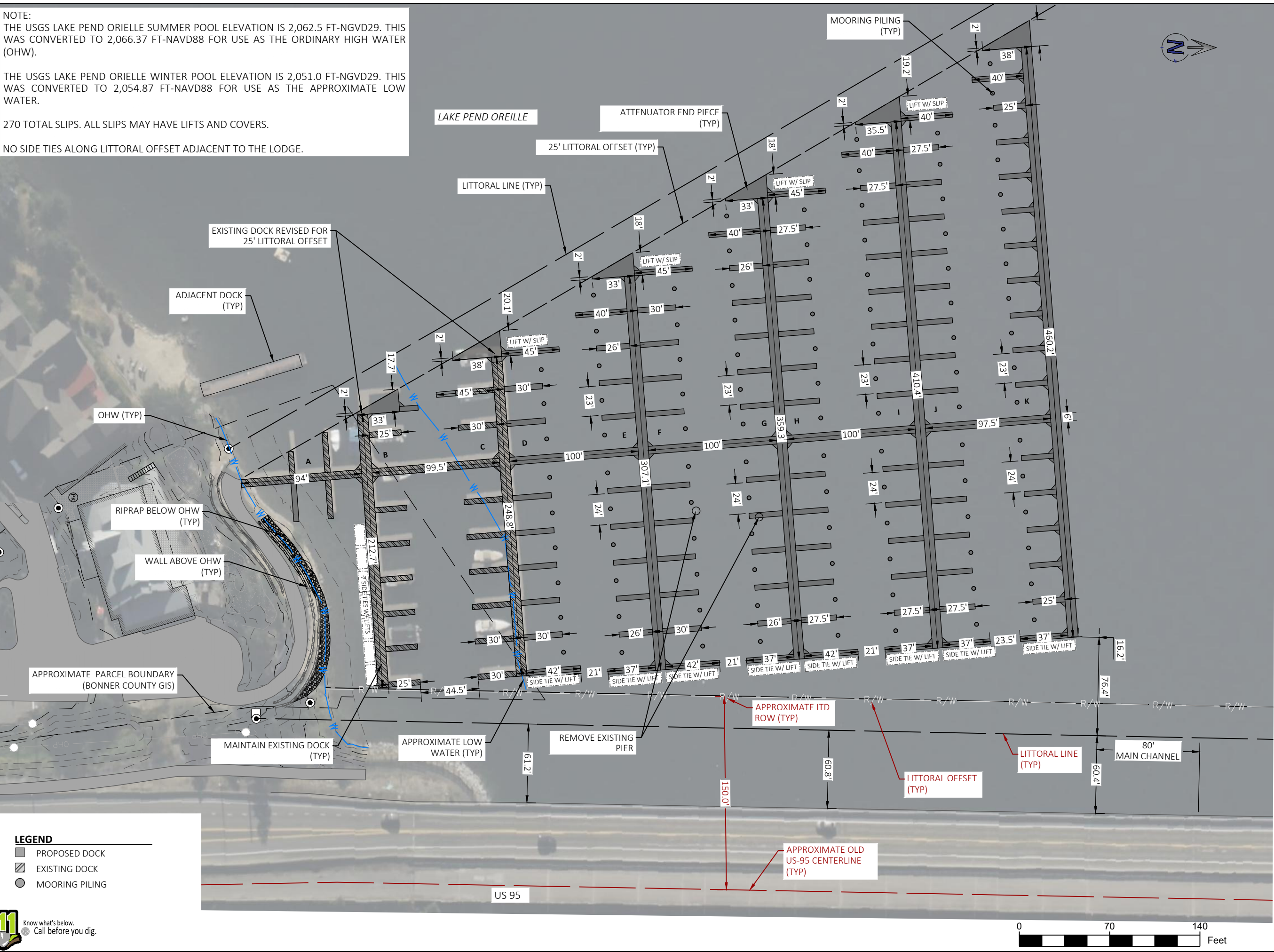

LONG BRIDGE LAKE ACCESS
BONNER COUNTY, ID

NOT
APPROVED
PRELIMINARY
FOR
CONSTRUCTION

1"
SCALE: (11X17 ONLY)

DWG:
PROJECT NO:
DRAWN BY:
CHECKED BY:
DATE:
© 2024 | ALL RIGHTS RESERVED
REVISIONS
NO. DATE BY DESCRIPTION

APPROXIMATE
RIGHT-OF-WAY
DRAWING:
SHEET: 1 OF 1